



# MODEL KW-7P & KW-7PD

## 3/8" Sq. Dr. Impact Wrench & Internal 1/4" Hex. Quick-Change Chuck

### EXPLODED VIEW



10721 S. WESTERN AVE. CHICAGO, IL 60643  
800-235-1782 FAX 773-779-0231

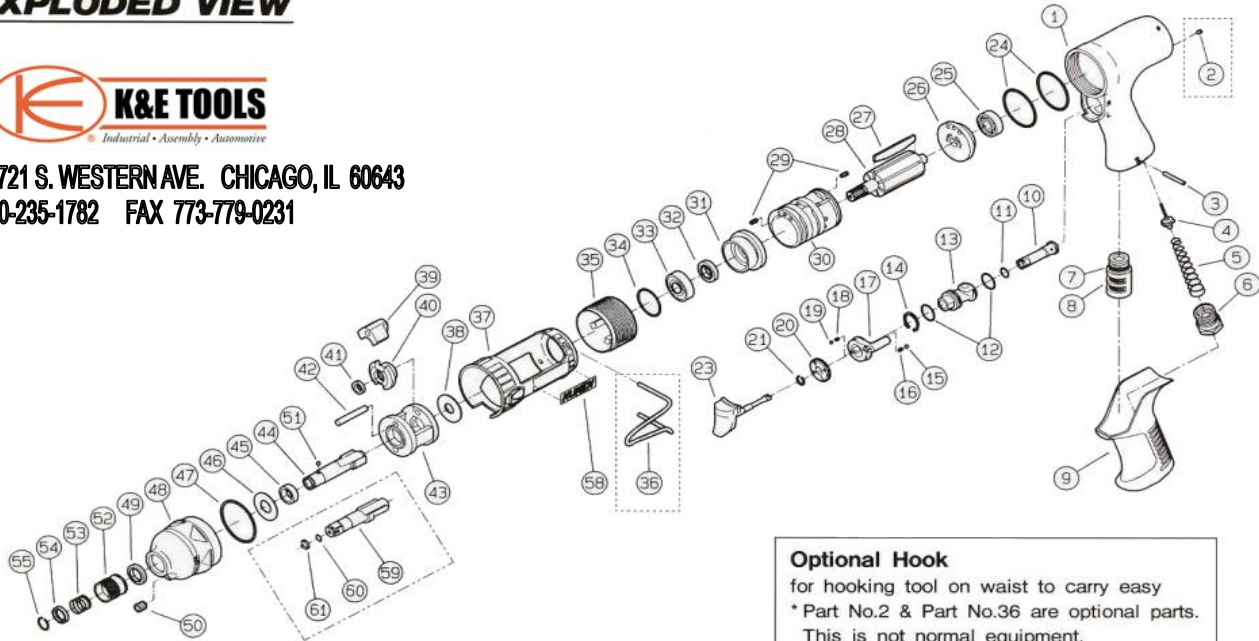

#### Optional Hook

for hooking tool on waist to carry easy  
\* Part No.2 & Part No.36 are optional parts.  
This is not normal equipment.

### REPAIR PARTS LIST

REF. #	NUMBER	PART NAME	QTY	REF. #	NUMBER	PART NAME	QTY
1	0207081	MOTOR CASE C.P.	1	31	0207023	FRONT END PLATE	1
2	Z0763X3	SET SCREW (OPTIONAL)	1	32	810194	OIL SEAL	1
3	Z0613X22	PIN	1	33	6000ZZ	BALL BEARING	1
4	02070131	THROTTLE VALVE	1	34	S-26	O RING	1
5	0207038	THROTTLE VALVE SPRING	1	35	0207039	JOINT	1
6	0207011	INLET BUSHING	1	36	0207099	HOOK (OPTIONAL)	1
7	P-12	O RING	1	37	02070041	PROTECTOR	1
8	0207040K	MUFFLER UNIT	1	38	0207025	SPACER	1
9	02070011	GRIP	1	39	0206128	HAMMER	2
10	0207017	REGULATOR VALVE	1	40	0207027	CAM	1
11	S-010	O RING	1	41	02070322	THRUST RING	1
12	S-15	O RING	1	42	HP5X314	HAMMER PIN	2
13	0207015	REVERSE VALVE	1	43	0206126	IMPACT CAGE	1
14	Z03017	STOP RING	1	44	0207030D	"D" ANVIL	1
15	3D	STEEL BALL	1	45	0207031	CAGE BUSHING	1
16	02070161	REVERSE LEVER SPRING	1	46	0207032	THRUST PLATE	1
17	0207016	REVERSE LEVER	1	47	S-40	O RING	1
18	02070181	R VALVE KNOB SPRING	1	48	0207002	CLUTCH CASE CP (#47 thru #50)	1
19	25D	STEEL BALL	1	49	812183	OIL SEAL	1
20	0207018	REGULATING VALVE KNOB	1	50	1/16D	PLUG	1
21	02070176	REGULATING VALVE RING	1	51	1/8D	STEEL BALL	1
23	0207012	THROTTLE LEVER	1	52	0207043	BALL STOPPER	1
24	S-36	O RING	1	53	02054302	BALL STOPPER SPRING	1
25	608ZZ	BALL BEARING	1	54	02054303	SPRING STOPPER	1
26	0207024	REAR END PLATE	1	55	826H60	RETAINER RING	1
27	0207022	ROTOR BLADE	7	59	0206130	3/8" SQ. DR. ANVIL	1
28	0207021	ROTOR	1		0207030P	PIN ANVIL KW-7P	1
29	Z0563X6	PIN	1	60	P-5	O RING	1
30	0207020	CYLINDER	1	61	0206132	RETAINER RING	1
**	0206195K	PIN ANVIL PARTS KIT	1		02061921	PIN	1
		**1 EA RETAINER, PIN, SPRING			0206193	SPRING	1
48-2	207008	HAMMER CASE BUSHING	1		0206194	RETAINER	1